

DIN 469

Crank handles

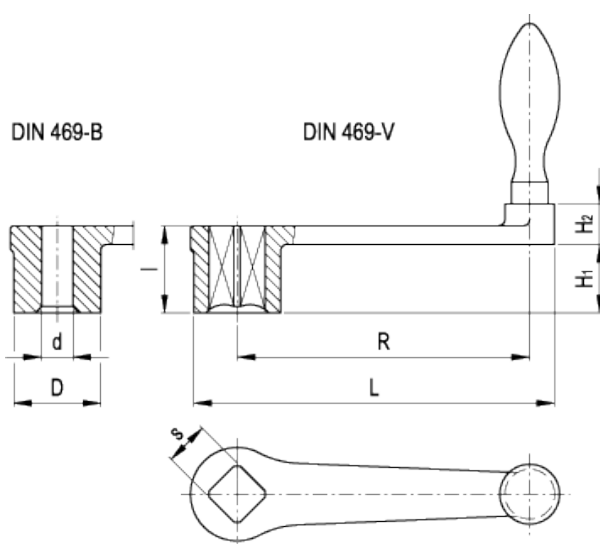

american unit
metric unit

Elesa-Gantergriff		Main dimensions	Mounting hole			Handle	Weight						
Handle D	Handle F		d _{H7}	s _{H11}	l		∅	Handle D	Handle F				
Code	Description	R	L	D	H ₁	H ₂	d _{H7}	s _{H11}	l	∅	lbs g	lbs g	
GN.11338	GN.11337	DIN 469-80-B8-*	3.15 80	4.02 102	0.94 24	0.71 18	0.51 13	0.31 8	- -	0.94 24	0.71 18	0.474 215	0.447 203
GN.11332	GN.11331	DIN 469-80-V10-*	3.15 80	4.02 102	0.94 24	0.71 18	0.51 13	-	0.39x0.39 10x10	0.94 24	0.71 18	0.421 191	0.394 179
GN.11334	GN.11333	DIN 469-80-V12-*	3.15 80	4.02 102	0.94 24	0.71 18	0.51 13	-	0.47x0.47 12x12	0.94 24	0.71 18	0.401 182	0.374 170
GN.11348	GN.11347	DIN 469-100-B10-*	3.94 100	4.88 124	1.1 28	0.83 21	0.51 13	0.39 10	- -	1.1 28	0.79 20	0.665 302	0.634 288
GN.11342	GN.11341	DIN 469-100-V12-*	3.94 100	4.88 124	1.1 28	0.83 21	0.51 13	-	0.47x0.47 12x12	1.1 28	0.79 20	0.628 285	0.597 271
GN.11344	GN.11343	DIN 469-100-V14-*	3.94 100	4.88 124	1.1 28	0.83 21	0.51 13	-	0.55x0.55 14x14	1.1 28	0.79 20	0.612 278	0.581 264
GN.11358	GN.11357	DIN 469-125-B10-*	4.92 125	6.06 154	1.34 34	1.02 26	0.55 14	0.39 10	- -	1.34 34	0.87 22	1.04 472	1.009 458

Elesa-Gantergriff			Main dimensions					Mounting hole			Handle	Weight	
Handle D	Handle F											Handle D	Handle F
Code		Description	R	L	D	H ₁	H ₂	d _{H7}	s _{H11}	l	∅	lbs g	lbs g
GN.11352	GN.11351	DIN 469-125-V14-*	4.92 125	6.06 154	1.34 34	1.02 26	0.55 14	- -	0.55x0.55 14x14	1.34 34	0.87 22	0.987 448	0.956 434
GN.11354	GN.11353	DIN 469-125-V17-*	4.92 125	6.06 154	1.34 34	1.02 26	0.55 14	- -	0.67x0.67 17x17	1.34 34	0.87 22	0.943 428	0.912 414
GN.11368	GN.11367	DIN 469-160-B14-*	6.3 160	7.56 192	1.5 38	1.14 29	0.55 14	0.55 14	- -	1.5 38	0.98 25	1.513 687	1.491 677
GN.11362	GN.11361	DIN 469-160-V17-*	6.3 160	7.56 192	1.5 38	1.14 29	0.55 14	- -	0.67x0.67 17x17	1.5 38	0.98 25	1.436 652	1.414 642
GN.11364	GN.11363	DIN 469-160-V19-*	6.3 160	7.56 192	1.5 38	1.14 29	0.55 14	- -	0.75x0.75 19x19	1.5 38	0.98 25	1.352 614	1.33 604
GN.11378	GN.11377	DIN 469-200-B17-*	7.87 200	9.37 238	1.73 44	1.34 34	0.83 21	0.67 17	- -	1.73 44	1.1 28	2.3 1044	2.249 1021
GN.11372	GN.11371	DIN 469-200-V19-*	7.87 200	9.37 238	1.73 44	1.34 34	0.83 21	- -	0.75x0.75 19x19	1.73 44	1.1 28	2.249 1021	2.198 998
GN.11374	GN.11373	DIN 469-200-V22-*	7.87 200	9.37 238	1.73 44	1.34 34	0.83 21	- -	0.87x0.87 22x22	1.73 44	1.1 28	2.198 998	2.137 970
GN.11388	GN.11387	DIN 469-250-B17-*	9.84 250	11.42 290	1.89 48	1.42 36	0.83 21	0.67 17	- -	1.89 48	1.26 32	3.128 1420	3.11 1412
GN.11382	GN.11381	DIN 469-250-V22-*	9.84 250	11.42 290	1.89 48	1.42 36	0.83 21	- -	0.87x0.87 22x22	1.89 48	1.26 32	2.952 1340	2.934 1332
GN.11384	GN.11383	DIN 469-250-V24-*	9.84 250	11.42 290	1.89 48	1.42 36	0.83 21	- -	0.94x0.94 24x24	1.89 48	1.26 32	2.839 1289	2.822 1281

* Complete the description of the standard item needed by adding the type of handle D or F listed in the code column.

Material

Nodular deburred cast iron, sandblasted matte finish.

Assembly

- Execution B: hub with H7 reamed through hole.
- Execution V: hub with H11 square through hole.

Handle

- Type D: turned and mirror-polished steel revolving handle type [DIN 98](#).
- Type F: turned and mirror-polished steel fixed handle type [DIN 39](#).



STANDARD MACHINE ELEMENTS WORLDWIDE

ELESA-GANTER models all rights reserved in accordance with the law. Always mention the source when reproducing our drawings.