

CFJ.

Tamperproof hinges

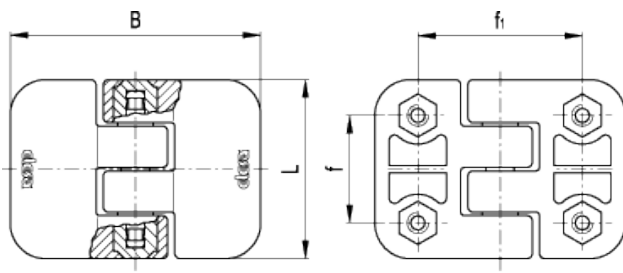

FM Design

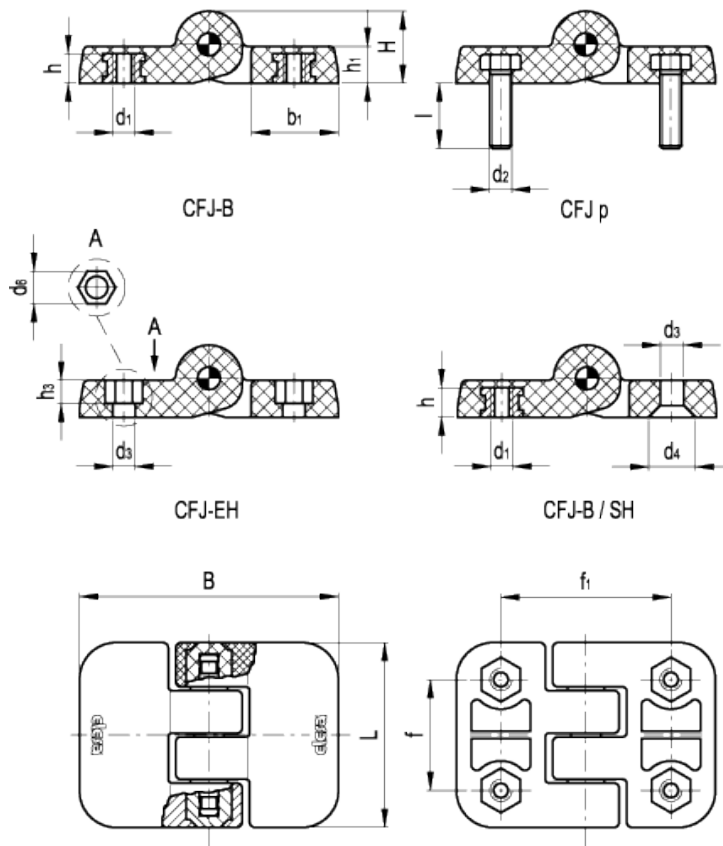

american unit
metric unit

Elesa Standards		Main dimensions							Fitting								Weight
									Bushings		Studs		Through holes				
Code	Description	L	B	f _{±.0098}	f _{1±.0098}	H	h ₁	b ₁	d ₁	h	d ₂	l	d ₃	d ₄	d ₆	h ₃	lbs g
424621	CFJ.50 p-M6x17	1.97 50	2.76 70	1.18 30	1.81 46	0.77 19.5	0.39 10	0.93 23.5	-	-	-	0.67 17	-	-	-	-	0.156 71
424631	CFJ.50 EH-6	1.97 50	2.76 70	1.18 30	1.81 46	0.77 19.5	0.39 10	0.93 23.5	-	-	-	-	0.26 6.5	-	0.39 10	0.22 5.5	0.101 46
424671	CFJ.50-R B-M6-SH-6	1.97 50	2.76 70	1.18 30	1.81 46	0.77 19.5	0.39 10	0.93 23.5	-	0.31 8	-	-	0.26 6.5	0.49 12.5	-	-	0.119 54

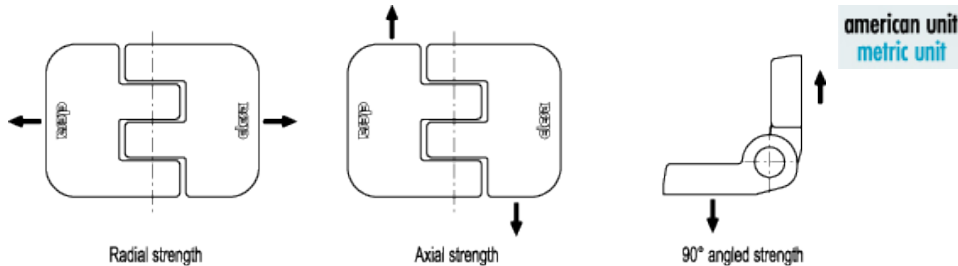

Elesa Standards		AXIAL STRENGTH		RADIAL STRENGTH		90° ANGLED STRENGTH		Maximum tightening torque [ft-lbf] [Nm]	
Code	Description	Maximum working load E _a [lbf] [N]	Load at breakage R _a [lbf] [N]	Maximum working load E _r [lbf] [N]	Load at breakage R _r [lbf] [N]	Maximum working load E ₉₀ [lbf] [N]	Load at breakage R ₉₀ [lbf] [N]	EH/SH	B p
424611	CFJ.50 B-M6	164 730	934 4170	497 2220	997 4450	159 710	504 2250	- -	4 5
424621	CFJ.50 p-M6x17	318 1420	988 4410	488 2180	974 4350	114 510	497 2220	- -	- 3 - 4
424631	CFJ.50 EH-6	390 1740	777 3470	334 1490	665 2970	103 460	475 2120	4 5	- -
424671	CFJ.50-R B-M6-SH-6	332 1480	623 2780	293 1310	558 2490	87 390	426 1900	2 3	4 5

Material

Glass-fibre reinforced polyamide based (PA) technopolymer. Resistant to solvents, oils, greases and other chemical agents.

Colour

Black, matte finish.

Rotation pin

AISI 303 stainless steel, totally moulded in the hinge body.

Assembly

- B: nickel-plated brass bushings, tapped hole.
- p: nickel-plated steel threaded studs.
- EH: through holes for hexagonal head screws.
- B/SH (SH = through holes for countersunk head screws).

Features and applications

The rotation pin totally moulded in the hinge body cannot be extracted, preventing any hinge tampering. This characteristic makes the hinge particularly suitable for mounting on structures or equipments requiring protection against intrusion.

Rotation angle

Max 270°, between 0° and -90° and between 0° and 180°

(0° = condition where the interconnected surfaces are on the same plane).

Do not exceed the rotation angle limit (see drawing) so as not to prejudice the hinge mechanical performance.

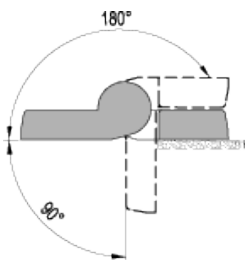

To choose the convenient type and the right number of hinges for your application see the [Guidelines](#).

Application example

