

# MSM-F

## Clamps for fixing sensor holders

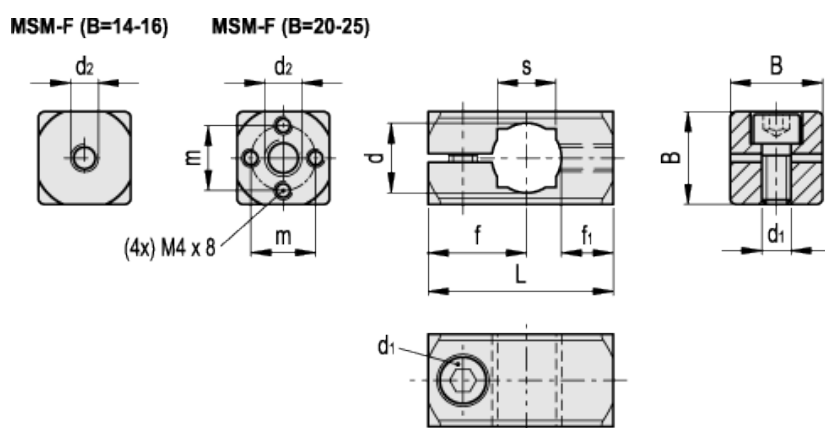

Elesa Standards		Main dimensions									GN 511 clamping kit for d1	Weight
Code	Description	d	d <sub>2</sub>	L	B	d <sub>1</sub>	f	f <sub>1</sub>	m	s		g
500101	MSM-F-8-M5-ANB	8	M5	25	14	M4	13.5	7.5	-	-	GN 511-M4-14	11
500105	MSM-F-10-M5-ANB	10	M5	30	16	M5	17	8	-	8	GN 511-M5-16	16
500109	MSM-F-10-M6-ANB	10	M6	30	16	M5	17	8	-	8	GN 511-M5-16	20
500113	MSM-F-10-M8-ANB	10	M8	30	16	M5	17	8	-	8	GN 511-M5-16	16
500117	MSM-F-12-M5-ANB	12	M5	32	16	M5	17	9	-	10	GN 511-M5-16	16
500121	MSM-F-12-M6-ANB	12	M6	32	16	M5	17	9	-	10	GN 511-M5-16	37
500125	MSM-F-12-M8-ANB	12	M8	32	16	M5	17	9	-	10	GN 511-M5-16	17
500129	MSM-F-15-M6-ANB	15	M6	40	20	M6	20.5	12	14	12	GN 511-M6-20	20
500133	MSM-F-15-M8-ANB	15	M8	40	20	M6	20.5	12	14	12	GN 511-M6-20	31
500137	MSM-F-16-M6-ANB	16	M6	40	20	M6	20.5	11.5	14	-	GN 511-M6-20	31
500141	MSM-F-16-M8-ANB	16	M8	40	20	M6	20.5	11.5	14	-	GN 511-M6-20	30
500145	MSM-F-20-M8-ANB	20	M8	45	25	M6	21.5	12	17	16	GN 511-M6-25	51
500149	MSM-F-20-M10-ANB	20	M10	45	25	M6	21.5	12	17	16	GN 511-M6-25	50
500103	MSM-F-8-M5-MT	8	M5	25	14	M4	13.5	7.5	-	-	GN 511-M4-14	11
500107	MSM-F-10-M5-MT	10	M5	30	16	M5	17	8	-	8	GN 511-M5-16	16
500111	MSM-F-10-M6-MT	10	M6	30	16	M5	17	8	-	8	GN 511-M5-16	20

Elesa Standards		Main dimensions									GN 511 clamping kit for d1	Weight
Code	Description	d	d <sub>2</sub>	L	B	d <sub>1</sub>	f	f <sub>1</sub>	m	s		g
500115	MSM-F-10-M8-MT	10	M8	30	16	M5	17	8	-	8	GN 511-M5-16	16
500119	MSM-F-12-M5-MT	12	M5	32	16	M5	17	9	-	10	GN 511-M5-16	16
500123	MSM-F-12-M6-MT	12	M6	32	16	M5	17	9	-	10	GN 511-M5-16	16
500127	MSM-F-12-M8-MT	12	M8	32	16	M5	17	9	-	10	GN 511-M5-16	15
500131	MSM-F-15-M6-MT	15	M6	40	20	M6	20.5	12	14	12	GN 511-M6-20	20
500135	MSM-F-15-M8-MT	15	M8	40	20	M6	20.5	12	14	12	GN 511-M6-20	31
500139	MSM-F-16-M6-MT	16	M6	40	20	M6	20.5	11.5	14	-	GN 511-M6-20	31
500143	MSM-F-16-M8-MT	16	M8	40	20	M6	20.5	11.5	14	-	GN 511-M6-20	30
500147	MSM-F-20-M8-MT	20	M8	45	25	M6	21.5	12	17	16	GN 511-M6-25	51
500151	MSM-F-20-M10-MT	20	M10	45	25	M6	21.5	12	17	16	GN 511-M6-25	50

**Material**  
Aluminium.

**Clamping screws**  
AISI 304 stainless steel with hexagon socket.

**Standard executions**  
- MSM-F-ANB: anodised aluminium, black colour.  
- MSM-F-MT: natural aluminium, matte finish.

**Features and applications**  
MSM-F connecting clamps have been designed in order to be used with [MSM-LA](#) and [MSM-LB](#) sensor holders.

**Dimension table key**  
d = hole diameter for shaft tolerance h11.  
d1 = clamping screws which can be replaced with [GN 511](#) clamping kit.

## GN 511

