

LV.F-125-ACV

Levelling elements for ground mounting

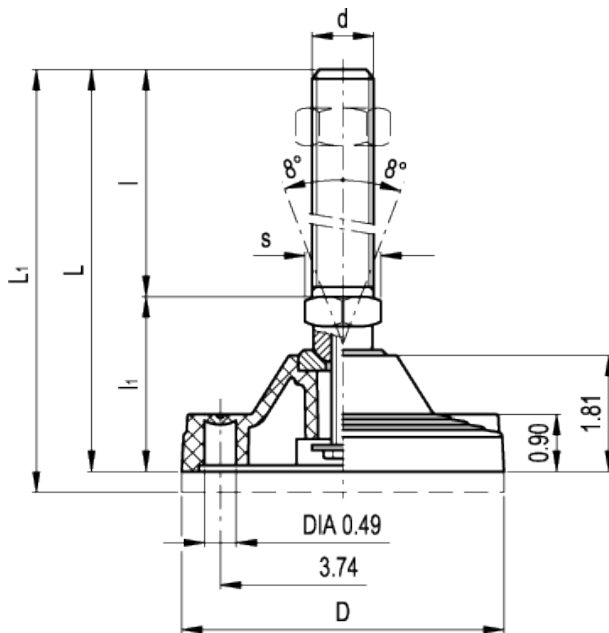

american unit
metric unit

Without no-slip disk		With no-slip disk		Main dimensions				Threaded stem		Wrench	Max limit static load*	Weight	
Code	Description	Code	Description	D	L	L _{1#}	I ₁	d	I	s	[lbf] [N]	lbs g	lbs# g
313921	LV.F-125-ACV-M20x136	316921	LV.F-125-ACV-AS-M20x136	4.92 125	7.87 200	8.27 210	2.52 64	- M20	5.35 136	0.94 24	8960 40000	1.289 585	1.839 835
313925	LV.F-125-ACV-M20x186	316925	LV.F-125-ACV-AS-M20x186	4.92 125	9.84 250	10.24 260	2.52 64	- M20	7.32 186	0.94 24	8960 40000	1.531 695	2.081 945
313931	LV.F-125-ACV-M24x136	316931	LV.F-125-ACV-AS-M24x136	4.92 125	7.87 200	8.27 210	2.52 64	- M24	5.35 136	0.94 24	8960 40000	1.619 735	2.17 985
313935	LV.F-125-ACV-M24x186	316935	LV.F-125-ACV-AS-M24x186	4.92 125	9.84 250	10.24 260	2.52 64	- M24	7.32 186	0.94 24	8960 40000	1.861 845	2.412 1095
313941	LV.F-125-ACV-M30x136	316941	LV.F-125-ACV-AS-M30x136	4.92 125	7.87 200	8.27 210	2.52 64	- M30	5.35 136	1.18 30	8960 40000	2.081 945	2.632 1195
313945	LV.F-125-ACV-M30x186	316945	LV.F-125-ACV-AS-M30x186	4.92 125	9.84 250	10.24 260	2.52 64	- M30	7.32 186	1.18 30	8960 40000	2.28 1035	2.83 1285

Without no-slip disk		With no-slip disk		Main dimensions				Threaded stem		Wrench	Max limit static load*	Weight	
Code	Description	Code	Description	D	L	L _{1#}	l ₁	d	l	s	[lbf] [N]	lbs g	lbs# g

* "Max limit static load" means the value over which the applied load to the element, in certain conditions of use, may cause plastic material deformation. # Data with no-slip disk mounted.

Base

Glass-fibre reinforced polyamide based (PA) technopolymer. Resistant to solvents, oils, greases and other chemical agents.

Colour

Black, matte finish.

Articulated through stem

Threaded zinc-plated steel and regulation hexagon.

Stem/base assembly

By means of zinc-plated steel set screw and washer.

Cup washers

Zinc-plated steel.

No-slip disk

NBR synthetic rubber, hardness 90 Shore A.

Standard executions

- LV.F: without no-slip disk.
- LV.F-AS: with no-slip disk, supplied assembled, reinforced with a zinc-plated steel plate and fixed by means of two screws.

Ground mounting

By means of two holes at 180°, covered by breakable plastic diaphragms which can be easily removed by a metal tool. They avoid all unhealthy deposits of dirt and dust when the ground mounting is not required (see below Assembly Instructions).

Accessories on request

Zinc-plated steel nut to be ordered separately (see Nuts [NT](#)).

Special executions on request (For sufficient quantities)

AISI 304 stainless steel stems.

Features and applications

The light knurling under the lower lip of the levelling element provides excellent stability and grip when using the levelling element without no-slip disk even on surfaces that are not perfectly flat.

The levelling element is supplied assembled.

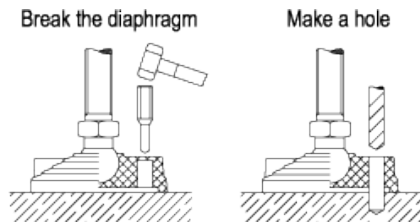

Fig.1