

HFLT-E

Level indicators with float and level electrical sensor

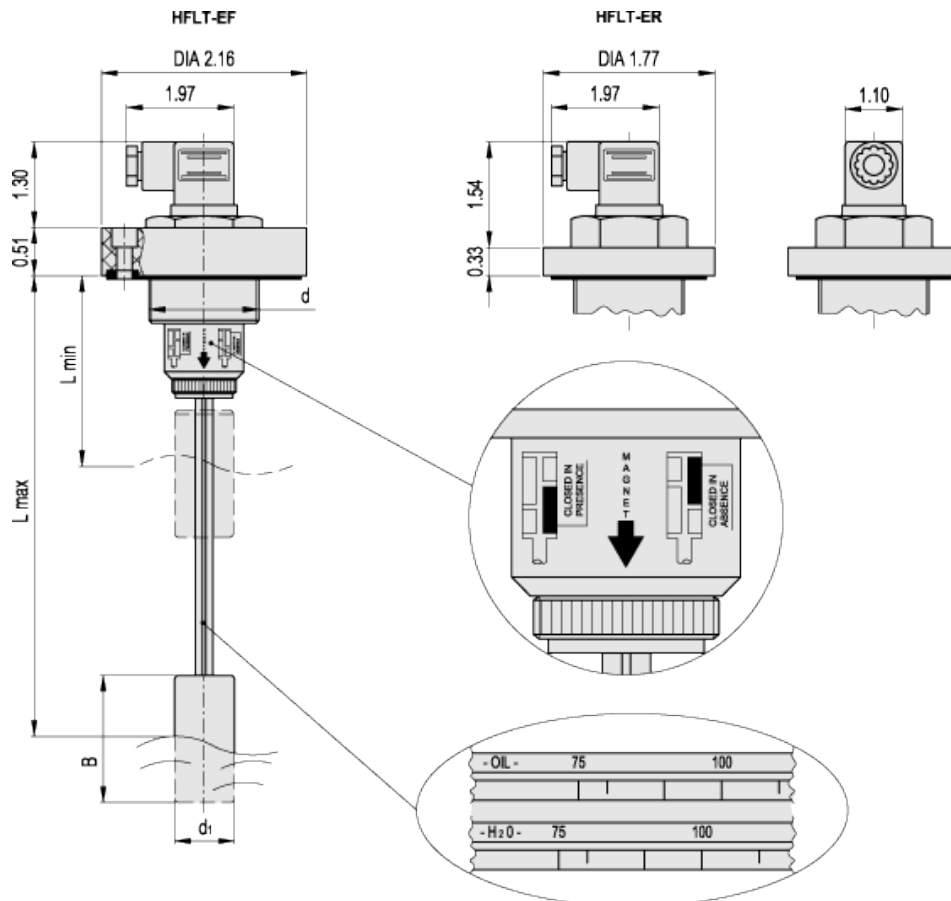

Drilling template for HFLT-EF

american unit
metric unit

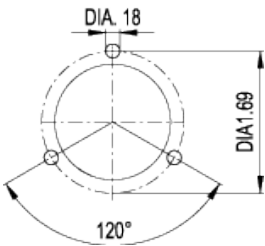

Elesa Standards		Main dimension					Weight
Code	Description	d	L min	L max	d ₁	B	lbs g
111276	HFLT-EF-3/4	- G 3/4	2.95 75	9.84 250	0.91 23	1.97 50	0.242 110
111278	HFLT-EF-1	- G 1	3.35 85	14.17 360	1.18 30	2.36 60	0.242 110
111271	HFLT-ER-3/4	- G 3/4	2.95 75	9.84 250	0.91 23	1.97 50	0.242 110
111273	HFLT-ER-1	- G 1	3.35 85	14.17 360	1.18 30	2.36 60	0.242 110
Description	Electric contacts					Electric contacts	
HFLT-E	Normally open (NO) or normally closed (NC) in the presence of liquid					1A 10W 10VA 100VDC 150VAC	

Material

Polyamide-based technopolymer (PA), colour grey. Resistant to solvents, oils, greases and other chemicals.

Packing rings

- TPE flat gasket (HFLT-EF).
- NBR synthetic rubber O-Ring (HFLT-ER).

Connector with sensor block

Side output, colour grey, with a built-in reed switch. Includes protection against water sprays with protection class IP 65 according to [UNI 529 table](#).

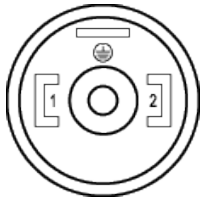

Dipstick

Featuring two raised scales (oil and water) marking the exact cutting point so as to obtain the desired set point (dimension L).

Standard executions

- HFLT-EF: flange with 3 holes at 120° for 3 socket head screws in galvanised steel, included in the supply in addition to the threaded coupler.
- HFLT-ER: threaded coupler.

Maximum continuous working temperature

80°C.

Special executions on request

- Polypropylene level indicators (PP).
- Flange with 6 holes for fastening with cylindrical head screws (included in the supply), in addition to threaded body.
- Level indicators for use with maximum working temperature up to 120°C.

Features and applications

Highly versatile, these indicators allow to define both the most accurate set point required by simply disassembling the dipstick float and cutting the dipstick exactly where needed, and the kind of operation required, with normally open (NO) or normally closed (NC) contact in the presence of liquid, by loosening the fastening nut on the opposite end of the dipstick and positioning the inner magnet according to specific requirements (refer to the adhesive label).

Free from magnetic parts, the float is integral to the dipstick making this level indicator ideal for use in tanks containing dirty liquids, water, oil, coolant oil, also with iron metal parts or foams. Moreover, the operation is independent of the fluid electrical conductivity.

To ensure utmost safety, the electrical components are separated from the tank and perfectly sealed by means of ultrasound welding.



STANDARD MACHINE ELEMENTS WORLDWIDE

ELESA models all rights reserved in accordance with the law. Always mention the source when reproducing our drawings.