

GN 426.1

Double-curved cabinet handles

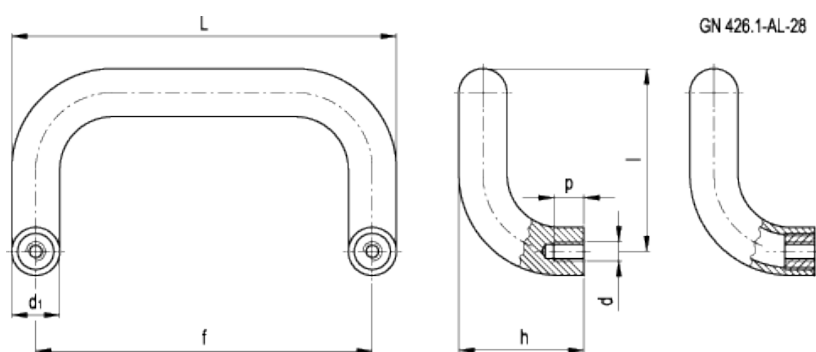

american unit
metric unit

Elesa-Gantergriff		Main dimensions					Mounting holes		Weight
Code	Description	L	f	h	d ₁	l	d	p	lbs g
GN.26961	GN 426.1-AL-20-200-SW	8.66 220	7.87 200	2.68 68	0.79 20	4.13 105	- M8	0.59 15	0.837 380
GN.26971	GN 426.1-AL-20-300-SW	12.6 320	11.81 300	2.68 68	0.79 20	4.13 105	- M8	0.59 15	1.046 475
GN.26991	GN 426.1-AL-28-250-SW	10.94 278	9.84 250	3.07 78	1.1 28	4.72 120	- M10	0.59 15	0.947 430
GN.27001	GN 426.1-AL-28-350-SW	14.88 378	13.78 350	3.07 78	1.1 28	4.72 120	- M10	0.59 15	1.112 505

Material

- Aluminium bar for DIA 0.79 (Ø 20 mm).
- Aluminium tube, thickness DIA 1.10 x 0.16 (Ø 28 x 4 mm).

Colour

Epoxy resin coating, RAL 9005 black colour, matte finish.

Assembly

- Tapped blind holes in the bar for DIA 0.79 (Ø 20 mm).
- Aluminium tapped bosses in the tube for DIA 1.10 (Ø 28 mm).

Special executions on request (For sufficient quantities)

Different lengths.

