

GH. Nuts

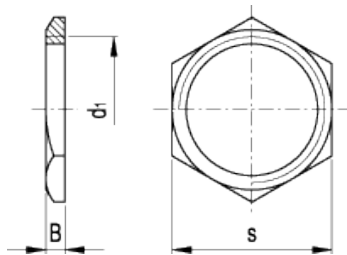

american unit
metric unit

Elesa Standards		Main dimensions			Weight
Code	Description	d ₁	B	s	lbs g
15001	GH. 3/8	- G 3/8	0.12 3	0.75 19	0.007 3
15011	GH. 1/2	- G 1/2	0.16 4	1.02 26	0.018 8
15021	GH. 3/4	- G 3/4	0.2 5	1.22 31	0.026 12
15031	GH. 1	- G 1	0.18 4.5	1.46 37	0.031 14
15041	GH. 1¼	- G 1¼	0.2 5	1.81 46	0.051 23
15051	GH. 2	- G 2	0.24 6	2.56 65	0.11 50

Material
Brass.

Features and applications

GH. nuts can be used for fitting the following indicators to reservoirs with wall thickness smaller than 0.20" (5 mm):

- [HGFT.](#)
- [GN 743](#)
- [GN 743.1](#)
- [GN 743.2](#)
- [GN 743.3](#)
- [HGFT.PR](#)
- [HGFT.HI-PR](#)
- [GN 744](#)
- [HFTX.](#)
- [HFTX.PR](#)
- [HCFE.](#)
- [HCFE/C](#)

