

DIN 6337

Clamping levers

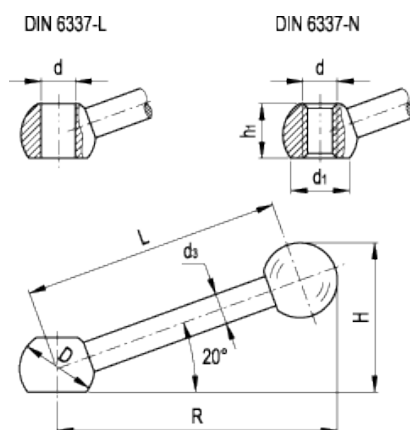

american unit
metric unit

Elesa-Gantergriff		Main dimensions						Mounting hole			Weight
Code	Description	R~	L	H~	D	d ₁	d ₃	d _{H7}	d	h ₁	lbs g
GN.10405	DIN 6337-63-B8-L	2.36 60	2.48 63	1.3 33	0.63 16	0.49 12.5	0.31 8	0.315 8	- -	0.47 12	0.07 32
GN.10401	DIN 6337-63-M8-N	2.36 60	2.48 63	1.3 33	0.63 16	0.49 12.5	0.31 8	- -	- M8	0.47 12	0.07 32
GN.10415	DIN 6337-80-B10-L	2.99 76	3.15 80	1.57 40	0.79 20	0.63 16	0.35 9	0.394 10	- -	0.57 14.5	0.117 53
GN.10411	DIN 6337-80-M10-N	2.99 76	3.15 80	1.57 40	0.79 20	0.63 16	0.35 9	- -	- M10	0.57 14.5	0.119 54
GN.10425	DIN 6337-100-B12-L	3.74 95	3.94 100	1.97 50	0.98 25	0.79 20	0.43 11	0.472 12	- -	0.73 18.5	0.22 100
GN.10421	DIN 6337-100-M12-N	3.74 95	3.94 100	1.97 50	0.98 25	0.79 20	0.43 11	- -	- M12	0.73 18.5	0.225 102
GN.10435	DIN 6337-125-B16-L	4.69 119	4.92 125	2.48 63	1.26 32	0.98 25	0.59 15	0.63 16	- -	0.94 24	0.476 216
GN.10431	DIN 6337-125-M16-N	4.69 119	4.92 125	2.48 63	1.26 32	0.98 25	0.59 15	- -	- M16	0.94 24	0.491 223
GN.10445	DIN 6337-160-B20-L	5.98 152	6.3 160	3.15 80	1.57 40	1.22 31	0.71 18	0.787 20	- -	1.18 30	0.914 415

Elesa-Gantergriff		Main dimensions						Mounting hole			Weight
Code	Description	R~	L	H~	D	d ₁	d ₃	d _{H7}	d	h ₁	lbs g
GN.10441	DIN 6337-160-M20-N	5.98 152	6.3 160	3.15 80	1.57 40	1.22 31	0.71 18	- -	- M20	1.18 30	0.936 425

Lever body

Turned and black-oxide steel.

Assembly

- Execution L: plain through hole.
- Execution N: tapped through hole.

Handle

Phenolic based (PF) Duroplast, black colour, glossy finish type [PL](#). Resistant to solvents, oils, greases and other chemical agents.



STANDAARD MACHINE ELEMENTS WORLDWIDE

ELESA-GANTER models all rights reserved in accordance with the law. Always mention the source when reproducing our drawings.