

DIN 6319-NI

Concave and convex washers

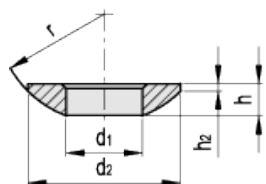

DIN 6319-C



DIN 6319-D (d4=d2)

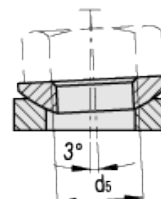
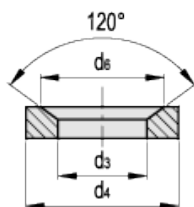

Elesa-Gantergriff		Main dimensions											Weight
Code	Description	d ₁ H12	d ₂	d ₃ H12	d ₄	d ₅ thread	d ₆	h	h ₁	h ₂	H	r	g
GN.30832	DIN 6319-6.4-C-NI	6.4	12	-	-	M6	-	2.3	-	0.7	4.2	9	1
GN.30836	DIN 6319-8.4-C-NI	8.4	17	-	-	M8	-	3.2	-	0.6	5.6	12	3
GN.30842	DIN 6319-10.5-C-NI	10.5	21	-	-	M10	-	4	-	0.8	6.5	15	5
GN.30846	DIN 6319-13-C-NI	13	24	-	-	M12	-	4.6	-	1.1	8	17	8
GN.30856	DIN 6319-17-C-NI	17	30	-	-	M16	-	5.3	-	1.3	9.6	22	13
GN.30862	DIN 6319-21-C-NI	21	36	-	-	M20	-	6.3	-	2	11.7	27	22
GN.30866	DIN 6319-25-C-NI	25	44	-	-	M24	-	8.2	-	2.4	15.2	32	43
GN.30872	DIN 6319-31-C-NI	31	56	-	-	M30	-	11.2	-	3.6	19.2	41	110
GN.30876	DIN 6319-37-C-NI	37	68	-	-	M36	-	14	-	4.6	23.5	50	190
GN.30882	DIN 6319-43-C-NI	43	78	-	-	M42	-	17	-	6.5	29	58	305
GN.30886	DIN 6319-50-C-NI	50	92	-	-	M48	-	21	-	8	35.5	67	540
GN.30902	DIN 6319-7.1-D-NI	-	-	7.1	12	M6	11	-	2.8	-	4.2	-	2
GN.30906	DIN 6319-9.6-D-NI	-	-	9.6	17	M8	14.5	-	3.5	-	5.6	-	4
GN.30912	DIN 6319-12-D-NI	-	-	12	21	M10	18.5	-	4.2	-	6.5	-	7
GN.30916	DIN 6319-14.2-D-NI	-	-	14.2	24	M12	20	-	5	-	8	-	10
GN.30926	DIN 6319-19-D-NI	-	-	19	30	M16	26	-	6.2	-	9.6	-	18
GN.30932	DIN 6319-23.2-D-NI	-	-	23.2	36	M20	31	-	7.5	-	11.7	-	31
GN.30936	DIN 6319-28-D-NI	-	-	28	44	M24	37	-	9.5	-	15.2	-	61
GN.30942	DIN 6319-35-D-NI	-	-	35	56	M30	49	-	12	-	19.2	-	130
GN.30946	DIN 6319-42-D-NI	-	-	42	68	M36	60	-	15	-	23.5	-	230

Elesa-Gantergriff		Main dimensions											Weight
Code	Description	d ₁ H12	d ₂	d ₃ H12	d ₄	d ₅ thread	d ₆	h	h ₁	h ₂	H	r	g
GN.30952	DIN 6319-49-D-NI	-	-	49	78	M42	70	-	18	-	29	-	360
GN.30956	DIN 6319-56-D-NI	-	-	56	92	M48	82	-	22	-	35.5	-	640

Standard executions

AISI 303 stainless steel.

- DIN 6319-C: convex washer.
- DIN 6319-D: concave washer.

Features and applications

DIN 6319-NI concave and convex washers are suitable for locking mechanical parts on non-parallel surfaces.



STANDARD MACHINE ELEMENTS WORLDWIDE

ELESA-GANTER models all rights reserved in accordance with the law. Always mention the source when reproducing our drawings.